

FLOORPLAN SKETCH

Borrower: Matt Weber	File No.: 3212145
Property Address: 5607 Longview St	Case No.: 122-2002114
City: Dallas	State: TX
Lender: Guild Mortgage - Corporate	Zip: 75206

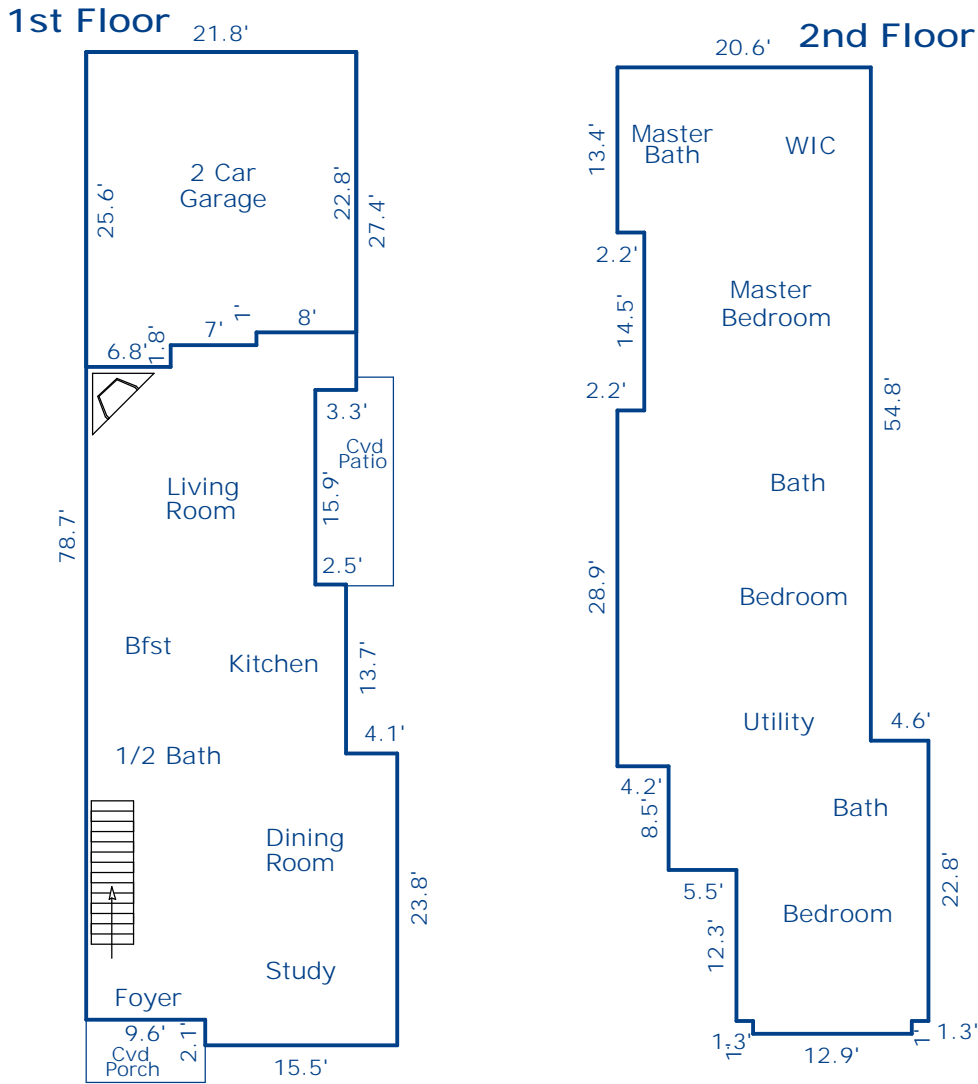

Sketch by Apex Sketch v5 Standard™

Comments:

AREA CALCULATIONS SUMMARY			
Code	Description	Net Size	Net Totals
GLA1	First Floor	1756.39	
	Garage	-523.08	1233.31
GLA2	Second Floor	1529.43	1529.43
Net LIVABLE Area		(rounded)	2763

LIVING AREA BREAKDOWN		
	Breakdown	Subtotals
First Floor		
	27.4 x 21.8	597.32
	15.9 x 18.5	294.15
	21.0 x 13.7	287.70
	25.1 x 21.7	544.67
	2.1 x 15.5	32.55
Garage		
	21.8 x 22.8	-497.04
	1.0 x 13.8	-13.80
	1.8 x 6.8	-12.24
Second Floor		
	13.4 x 20.6	276.04
	25.2 x 2.0	50.40
	26.9 x 20.6	554.14
	14.5 x 18.4	266.80
	1.0 x 12.9	12.90
	12.3 x 15.5	190.65
	8.5 x 21.0	178.50
15 Items	(rounded)	2763

FLOORPLAN SKETCH

Borrower: Matt Weber	File No.: 3212145	
Property Address: 5607 Longview St	Case No.: 122-2002114	
City: Dallas	State: TX	Zip: 75206
Lender: Guild Mortgage - Corporate		

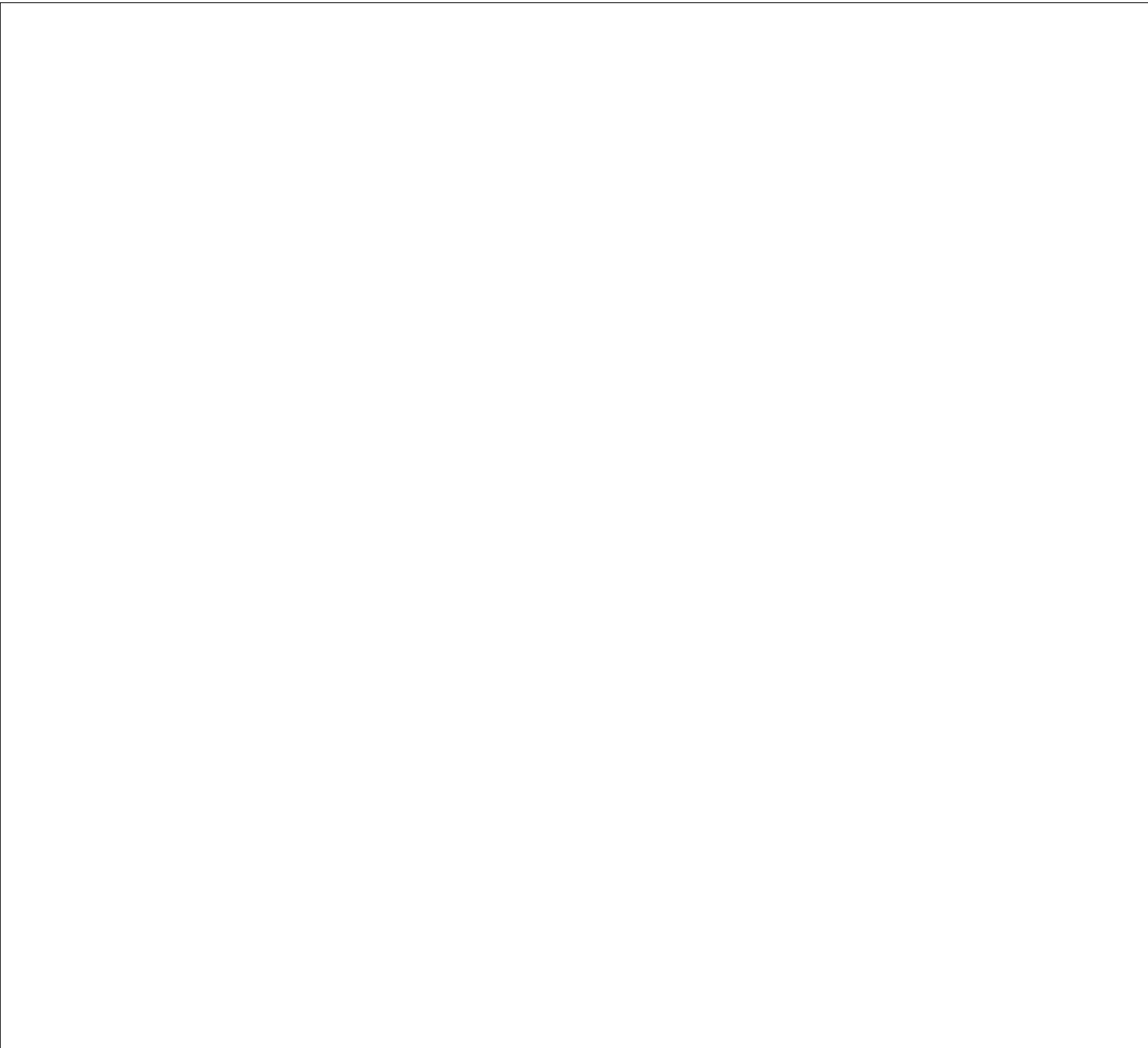

Sketch by Apex Sketch v5 Standard™

Comments:

AREA CALCULATIONS SUMMARY			
Code	Description	Net Size	Net Totals

AREA BREAKDOWN	
Breakdown	Subtotals

Borrower: Matt Weber	File No.: 3212145	
Property Address: 5607 Longview St	Case No.: 122-2002114	
City: Dallas	State: TX	Zip: 75206
Lender: Guild Mortgage - Corporate		

Texas Appraiser Licensing and Certification Board

P.O. Box 12188 Austin, Texas 78711-2188

Certified Residential Real Estate Appraiser

Number: **TX 1334575 R**
Issued: **01/24/2019** Expires: **02/28/2021**
Appraiser: **JASON COYLE YESKE**



Having provided satisfactory evidence of the qualifications required by the Texas Appraiser Licensing and Certification Act, Texas Occupations Code, Chapter 1103, is authorized to use this title, Certified Residential Real Estate Appraiser.

Douglas E. Oldmixon
Commissioner