

101 - 2311 MILLS ROAD

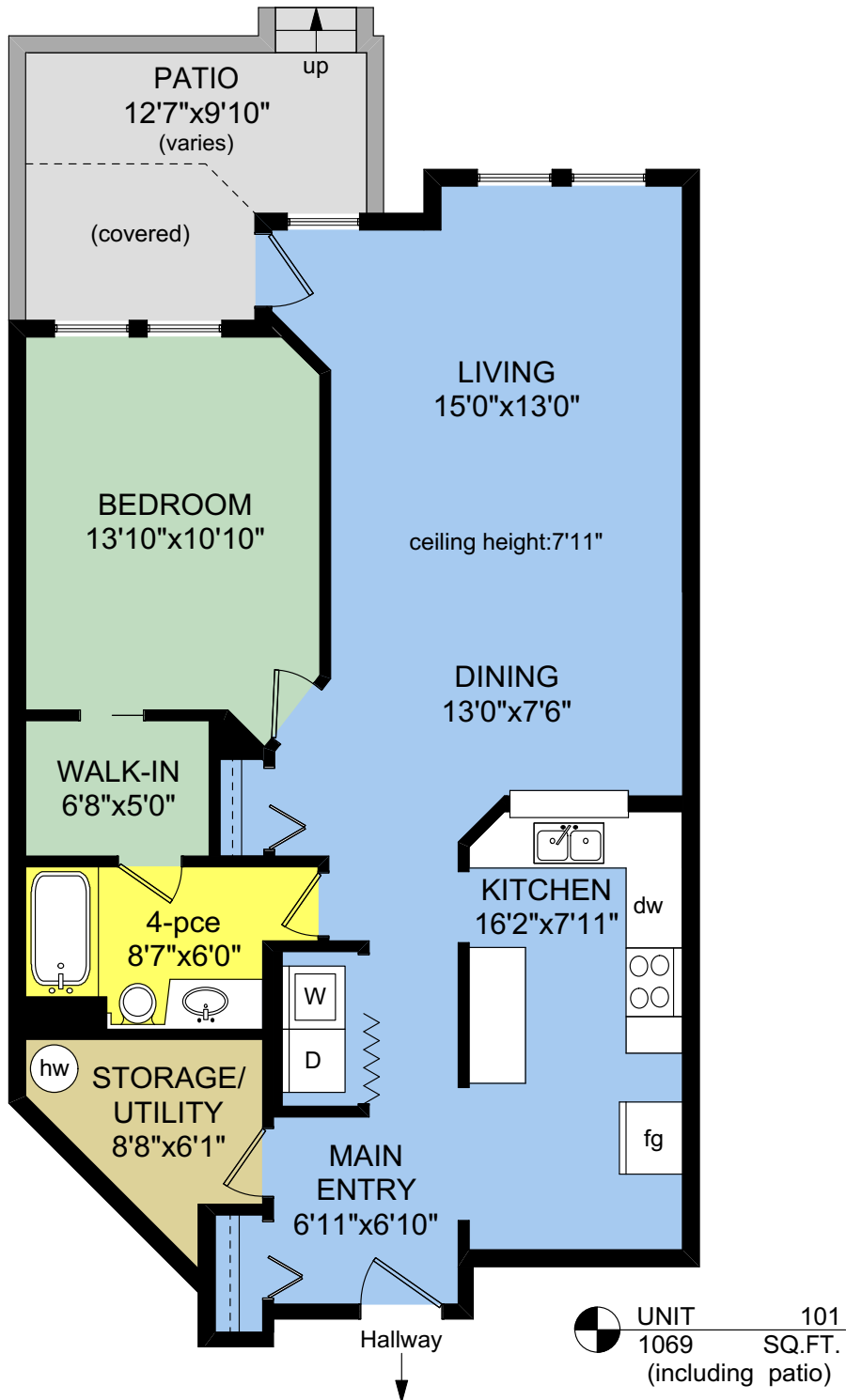

NOTE: The room name labels/sizes are for viewing reference only. They are not to be used for calculating total square footage.

Strata Total 1,069 Sq.Ft. (including patio)

	FINISHED SQ. FT.	UNFINISHED SQ. FT.	TOTAL SQ. FT.
MAIN	943	0	943
PATIO	0	126	126
TOTAL	943	126	1069

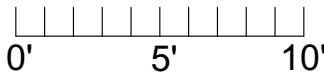

PREPARED FOR THE EXCLUSIVE USE OF
 NIELS MADSEN & DAVID LANGLOIS,
 PERSONAL REAL ESTATE CORPORATION,
 MACDONALD REALTY Ltd.

MEASURED ON: 09/01/21
 DRAWING FILE: 18056

Tafe Measure VICTORIA, B.C.
 Ph. 883.8894
 www.tafemeasure.com