

# 535 NE 93rd Ave, Portland, OR 97220

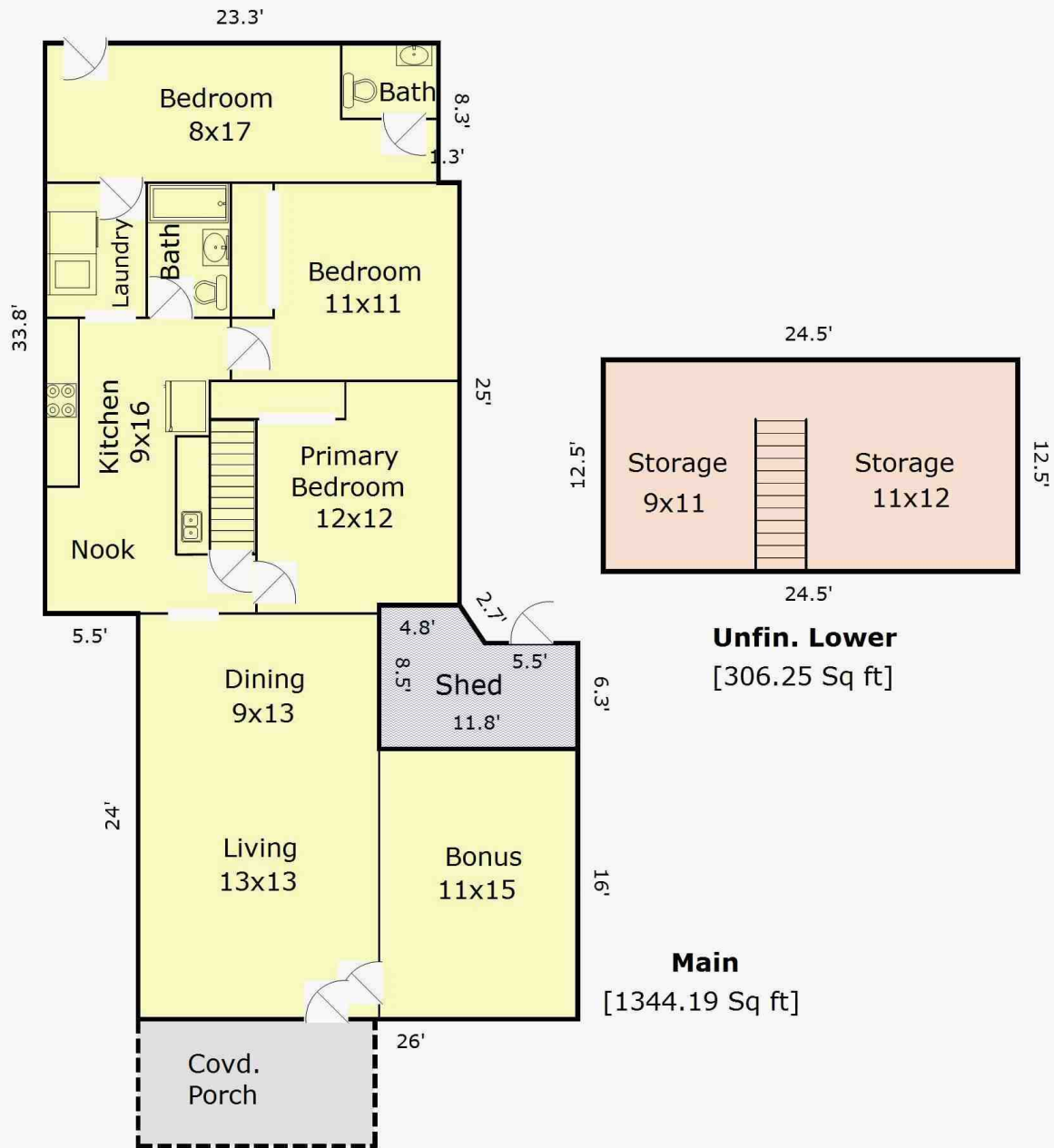

**Main + Upper = 1,650 Sq ft**

Sketch Prepared for Dill Ward  
Measured on 07/26/21

This sketch and the measurements shown hereon, are approximate and are only provided for rough demonstrative purposes. The measurements are not guaranteed and should not be relied upon. If measurements are material to the reader, then the reader should independently measure the dimensions. This sketch is provided to the preparer's client along with various limitations and conditions that apply to this sketch and which should be reviewed along with this sketch. If a person other than the designated Client uses the information herein (despite a prohibition on such use), then such person agrees to be subject to the same terms and limitation as the designated Client. Separation of this text from the sketch above will subject the separating party to liability.

Order floor plan drawing services at [www.AQualityMeasurement.com](http://www.AQualityMeasurement.com)

