

FLOORPLAN SKETCH

Borrower:	File No.: c0820ramshorn
Property Address: 1001 Ramshorn Dr	Case No.:
City: Estes Park	State: CO
Lender: Agent: Amanda Hicks	Zip: 80517

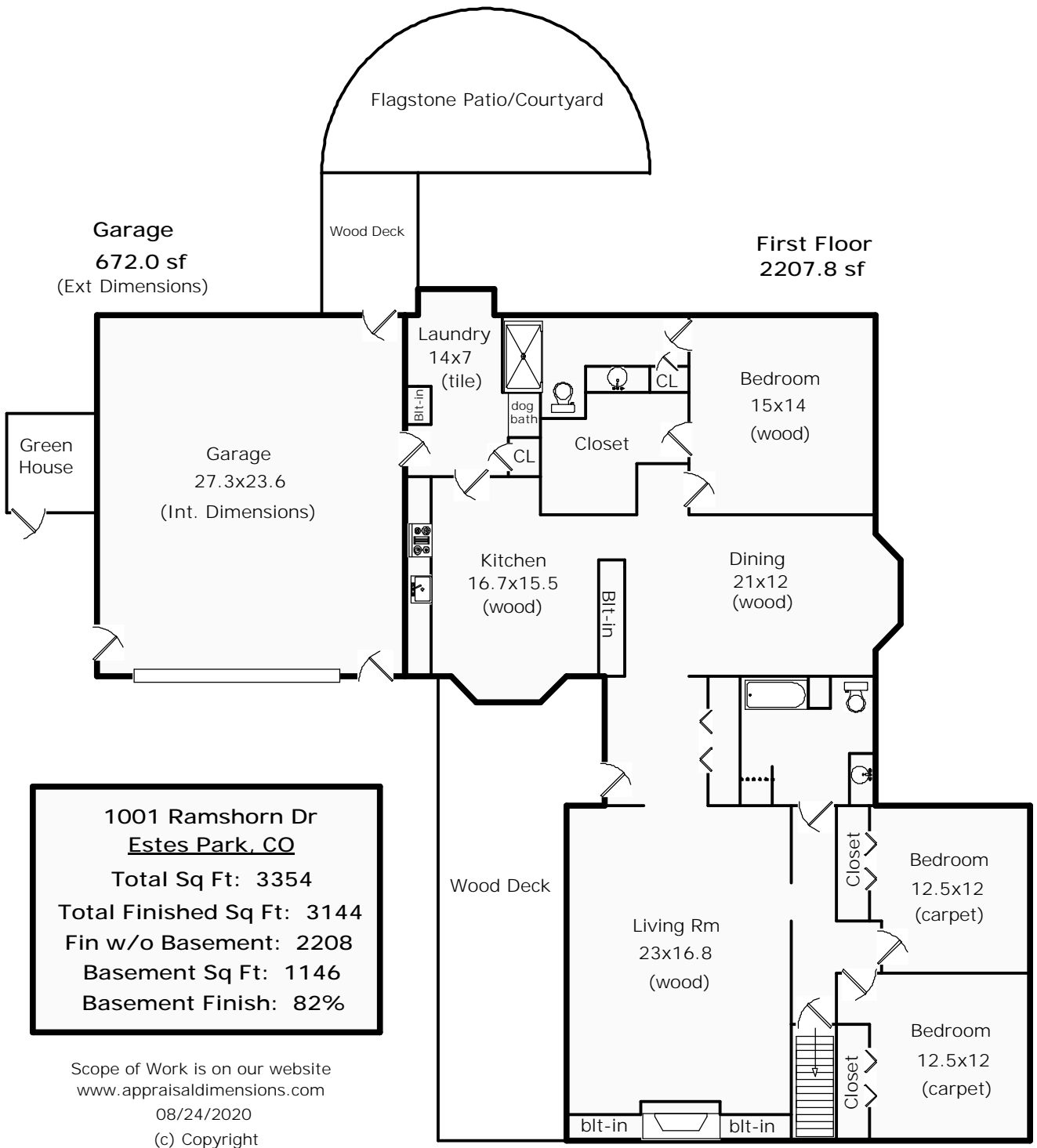

1001 Ramshorn Dr
 Estes Park, CO
 Total Sq Ft: 3354
 Total Finished Sq Ft: 3144
 Fin w/o Basement: 2208
 Basement Sq Ft: 1146
 Basement Finish: 82%

Scope of Work is on our website
www.appraisaldimensions.com
 08/24/2020
 (c) Copyright

Sketch by Apex Sketch v5 Standard™

FLOORPLAN SKETCH

Borrower: _____ File No.: c0820ramshorn
Property Address: 1001 Ramshorn Dr _____ Case No.: _____
City: Estes Park _____ State: CO _____ Zip: 80517
Lender: Agent: Amanda Hicks _____

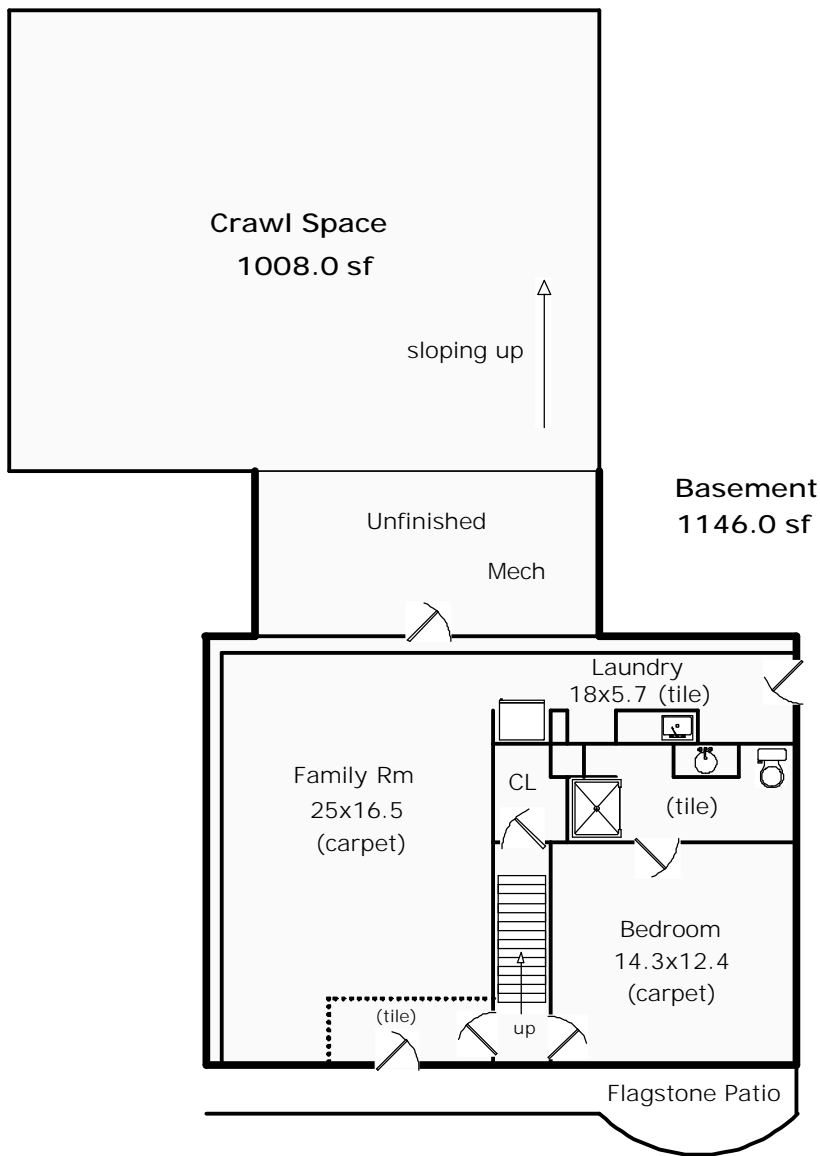

FLOORPLAN SKETCH

Borrower:	File No.: c0820ramshorn
Property Address: 1001 Ramshorn Dr	Case No.:
City: Estes Park	State: CO
Lender: Agent: Amanda Hicks	Zip: 80517

AREA CALCULATIONS SUMMARY			
Code	Description	Net Size	Net Totals
GLA1	First Floor	2207.80	2207.80
GAR	Garage	672.00	672.00
BSMT	Basement	1146.00	1146.00
OTH	Crawl Space	1008.00	1008.00
Net LIVABLE Area		(rounded)	2208

LIVING AREA BREAKDOWN			
	Breakdown	Subtotals	
First Floor			
0.5 x	2.0 x 2.0	2.00	2.00
	10.0 x 21.0	210.00	210.00
	36.5 x 4.0	146.00	146.00
0.5 x	2.0 x 2.0	2.00	2.00
	5.0 x 2.0	10.00	10.00
	36.0 x 26.0	936.00	936.00
	5.0 x 38.5	192.50	192.50
0.5 x	2.0 x 2.0	2.00	2.00
0.5 x	2.0 x 2.0	2.00	2.00
	19.0 x 36.5	693.50	693.50
	2.0 x 5.9	11.80	11.80
11 Items		(rounded)	2208

First Floor		GLA1	
0.5 x	2.0 x	2.0 =	2.00
	10.0 x	21.0 =	210.00
	36.5 x	4.0 =	146.00
0.5 x	2.0 x	2.0 =	2.00
	5.0 x	2.0 =	10.00
	36.0 x	26.0 =	936.00
	5.0 x	38.5 =	192.50
0.5 x	2.0 x	2.0 =	2.00
0.5 x	2.0 x	2.0 =	2.00
	19.0 x	36.5 =	693.50
	2.0 x	5.9 =	11.80

Garage		GAR	
28.0 x	24.0 =	672.00	

Area total (rounded) = 2208

Area total (rounded) = 672

Basement		BSMT	
36.0 x	26.0 =	936.00	
10.0 x	21.0 =	210.00	

Crawl Space		OTH	
28.0 x	36.0 =	1008.00	

Area total (rounded) = 1146

Area total (rounded) = 1008