

Building Sketch (Page - 1)

Borrower				
Property Address	1312 Magnolia ave			
City	Norfolk	County	State	VA Zip Code 23508-1148
Lender/Client	N/A			

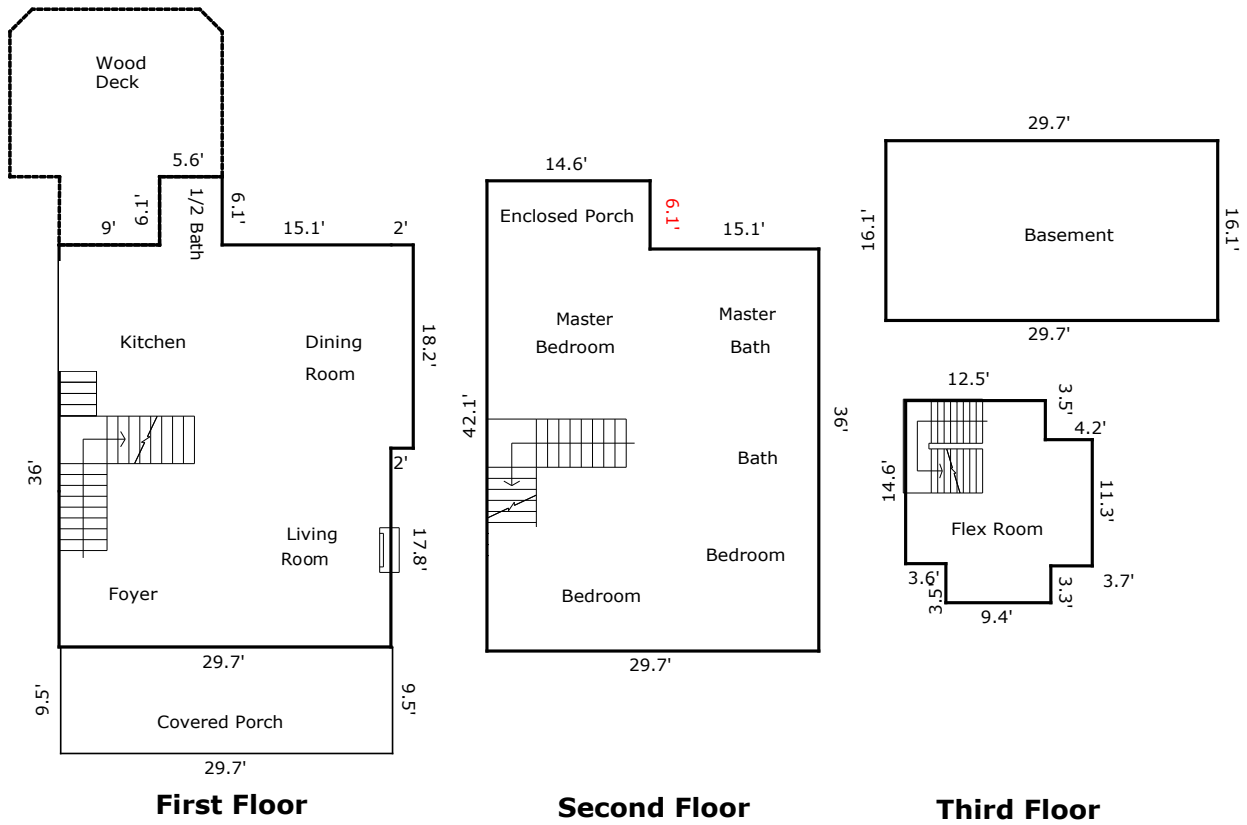

TOTAL Sketch by a la mode, inc.

Building Sketch (Page - 2)

Borrower				
Property Address	1312 Magnolia ave			
City	Norfolk	County	State	VA Zip Code 23508-1148
Lender/Client	N/A			

TOTAL Sketch by a la mode, inc.

Area Calculations Summary

Living Area	Calculation Details		
First Floor	1139.8 Sq ft	$5.6 \times 6.1 = 34.2$	$36 \times 29.7 = 1069.2$
		$2 \times 18.2 = 36.4$	
Second Floor	1158.3 Sq ft	$29.7 \times 36 = 1069.2$	$14.6 \times 6.1 = 89.1$
Third Floor	262.8 Sq ft	$9.4 \times 3.3 = 31$	$11.3 \times 4.2 = 47.5$
		$12.5 \times 14.6 = 182.5$	$0.2 \times 8.9 = 1.8$
Total Living Area (Rounded):	2561 Sq ft		
Non-living Area			
Covered Porch	282.1 Sq ft	$9.5 \times 29.7 = 282.2$	
Wood Deck	335.7 Sq ft	$0.5 \times 6.1 \times 0 = 0.2$	$9 \times 6.1 = 54.6$
		$19 \times 13 = 247$	$15 \times 2 = 30$
		$0.5 \times 2 \times 2 = 2$	$0.5 \times 2 \times 2 = 2$
Basement	478.2 Sq ft	$16.1 \times 29.7 = 478.2$	