

**SURVEYOR'S REAL PROPERTY REPORT  
PART 1  
PLAN OF LOT 79  
PLAN 65M-4635  
TOWN OF AURORA  
REGIONAL MUNICIPALITY OF YORK**

SCALE 1:300  
10m 5m 0 10m 20 metres

R-PE SURVEYING LTD., O.L.S.

METRIC

DISTANCES SHOWN ON THIS PLAN ARE IN METRES AND CAN BE CONVERTED TO FEET BY DIVIDING BY 0.3048.

**PART 2 (SURVEY REPORT)**

REGISTERED EASEMENTS AND/OR RIGHT-OF-WAYS: PART OF LOT 79 DESIGNATED AS PART 48, PLAN 65R-38312 IS SUBJECT TO AN EASEMENT IN GROSS AS IN YR2935736. THIS PLAN DOES NOT CERTIFY COMPLIANCE WITH ZONING BY-LAWS

**SURVEYOR'S CERTIFICATE**

I CERTIFY THAT:

1. THIS SURVEY AND PLAN ARE CORRECT AND IN ACCORDANCE WITH THE SURVEYS ACT, THE SURVEYORS ACT AND THE LAND TITLES ACT AND THE REGULATIONS MADE UNDER THEM.
2. THE SURVEY WAS COMPLETED ON THE 4<sup>th</sup> DAY OF JUNE, 2019.

DATE JUNE 6, 2019.

T. SINGH  
ONTARIO LAND SURVEYOR

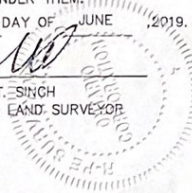

66 Lot 79

PLAN

**BOTELHO CIRCLE**

(BY PLAN 65M-4635)  
P.I.N. 03642-5804

**ASSOCIATION OF ONTARIO  
LAND SURVEYORS  
PLAN SUBMISSION FORM  
2088754**

THIS PLAN IS NOT VALID UNLESS IT IS AN EMBOSSED ORIGINAL COPY ISSUED BY THE SURVEYOR In accordance with Regulation 1026, Section 29(3).

**NOTES**

- DENOTES MONUMENT SET
- DENOTES MONUMENT FOUND
- IB DENOTES IRON BAR
- SSIB DENOTES SHORT STANDARD IRON BAR
- D.U.C. DENOTES DWELLING UNDER CONSTRUCTION
- P.I.N. DENOTES PROPERTY IDENTIFIER NUMBER
- P DENOTES PORCH
- PL DENOTES PLAN 65M-4635
- T.O.W. DENOTES TOP OF WALL ELEVATION

ALL FOUND MONUMENTS BY SCHAEFFER DZALDOV BENNETT LTD., O.L.S.

ALL TIES TO CONCRETE FOUNDATION.

BEARINGS ARE ASTRONOMIC AND ARE REFERRED TO THE SOUTHEASTERLY LIMIT OF BOTELHO CIRCLE AS SHOWN ON PLAN 65M-4635 HAVING A BEARING OF N72°41'10"E.

MEASURED BEARINGS CAN BE CONVERTED TO GRID UTM ZONE 17, NAD83 (ORIGINAL) BY APPLYING A COUNTER CLOCKWISE ROTATION OF 1°05'25".

THIS REPORT WAS PREPARED FOR LAKEVIEW HOMES AND THE UNDERSIGNED ACCEPTS NO RESPONSIBILITY FOR USE BY OTHER PARTIES

© R-PE SURVEYING LTD., O.L.S., 2019.



**R-PE SURVEYING LTD.**

ONTARIO LAND SURVEYORS  
643 Chrislea Road, Suite 7  
Woodbridge, Ontario L4L 8A3  
Tel. (416) 635-5000 Fax (416) 635-5001  
Tel. (905) 264-0881 Fax (905) 264-2099

Website: www.r-pe.ca

DRAWN: V.H.

CHECKED: G.Y./T.S.

JOB No. 18-103

CAD FILE No. 4635-79

